



# WOLF E-NEWS

*from Westside High School*

14201 Briar Forest Houston, Texas 77077 \* Phone: 281.920.8000 \* Fax: 281.920.8059

March 31, 2020

## Westside @ HOME Launches Today!

Blast off! Today we launch "Westside @ HOME", our home-based online mobile education program, in response to the extended Covid-19 school closures. As we embark on this new adventure, we do expect a bit of light turbulence so let's buckle our seatbelts and get through this together. We are aware our launching pad, the student HUB, is sluggish due to high-volume traffic. Please be patient.

If you missed Principal Stewart's Live-Streamed information meetings over the last few days, you can catch up by viewing slides and video recordings of the meetings. Go to the Westside homepage, [www.westsidewolves.org](http://www.westsidewolves.org), and click the pink button for Virtual Presentations under Current Headlines (or click [here](#)). This section will be updated as new meetings are held, so check back regularly for updates and additions.

This week's 4-day schedule is here at right. Next week, we will follow the same 4-day schedule on Monday

through Thursday, and we have Spring Holiday on Friday.

It is vital for parents and students to stay connected and on top of rapidly-changing information/announcements. Parents, if you have not already done so, please fill out and submit this [Parent Info Form](#) so we can be sure to reach all of our Wolves. Students are asked to check their HISD

student email regularly as they will receive important messages from teachers and deans. If they have not yet connected, students may [email their teachers/dean](#). If students are still confused or do not know where to begin, they may contact Ms. Merriweather, our Curriculum Instructional Technologist, at [ameriwe@houstonisd.org](mailto:ameriwe@houstonisd.org).

We will get through this together, Wolves! Hang in there.

	TUESDAY	WEDNESDAY	THURSDAY	FRIDAY
	Periods 1,3,5,7 ONLY		Periods 2,4,6 ONLY	
	Periods 1,3,5,7 academic work due on <b>Thursdays</b>		Periods 2,4,6 academic work due on <b>Mondays</b>	
	Teacher-Directed Instruction Intro to Learning Objective Instructional Process Teacher-Student Engagement (Live or Pre-recorded Lessons)	Supplemental Teacher Directed Instruction Independent Student Practice Performance Task Completion Progress Monitoring	Teacher-Directed Instruction Intro to Learning Objective Instructional Process Teacher-Student Engagement (Live or Pre-recorded Lessons)	Supplemental Teacher Directed Instruction Independent Student Practice Performance Task Completion Progress Monitoring
9:30-12:00	Per 1- 9:30-10:30  Per 3- 11:00-12:00	Per 1- 9:30-10:30  Per 3- 11:00-12:00	Per 2- 9:30 - 10:30  Per 4- 11:00-12:00	Per 2- 9:30 - 10:30  Per 4- 11:00-12:00
	Lessons recorded & saved for student viewing-anytime.	More student-teacher interaction on this day	Lessons recorded & saved for student viewing-anytime.	More student-teacher interaction on this day
12:00-1:00	LUNCH	LUNCH	LUNCH	LUNCH
1:00-3:00	Per 5- 1:00- 2:00 Per 7- 2:00- 3:00	Per 5- 1:00- 2:00 Per 7- 2:00- 3:00	Per 6- 1:00 - 2:00	Per 6- 1:00 - 2:00
3:00-3:30	Troubleshooting/ Parent-Student Contact/Dean Referral	Troubleshooting/ Parent-Student Contact/Dean Referral	2:00 PM on WED & THURS TEACHER MEETINGS/ TECH TRAINING AND/OR SUPPORT UPON REQUEST	

## Are You In the Loop?

During these challenging times of students learning at home, it is important to stay connected. Please be proactive in keeping up to date on the information you need. Things change rapidly so you will need to be vigilant.

**Are you in the loop?** The first priority related to school is for parents to ensure you are receiving notices from HISD and Westside High School. All parents are asked to fill out this brief form ASAP so we can be sure we are connecting with you. Click here: [PARENT INFO FORM](#)

**Is your student in the loop?** Students need to check their **HISD email** inbox regularly. Teachers, deans, administrators and other staff will be communicating with students directly via their HISD student email. Please coach students to check it regularly to stay up-to-date.

**Are you subscribed to the eNews?** The Wolf eNews contains valuable announcements and school news. Click [here](#) to subscribe and get it delivered to your email inbox.

**Are you signed up to use Grade Speed?** Parents and students can stay on top of grades and assignments. Click [here](#) to register.



Seek out reliable information to stay on top of the latest updates and details. Now is a great time to follow *trusted* social media resources and sign-up for notifications from official entities. Do not rely on word of mouth nor internet rumors.

### SEEK OUT RELIABLE INFORMATION TO STAY UPDATED

#### Houston Independent School District

Main Website: [www.houstonisd.org](http://www.houstonisd.org)

HISD/Covid-19 Alerts: [www.houstonisd.org/HealthAlerts](http://www.houstonisd.org/HealthAlerts)

Twitter: @HoustonISD

Instagram: houstontxisd

FaceBook: Houston Independent School District

#### City of Houston

Main website: [www.houstontx.gov](http://www.houstontx.gov)

Covid-19 Updates: <https://houstonemergency.org/covid19>

Twitter: @HoustonTX

#### Westside High School

Main Website: [www.westsidewolves.org](http://www.westsidewolves.org)

Twitter: @westsidehigh

Instagram: gowestsidewolves

Facebook: Westside High School

#### Harris County

Main Website: [www.harriscountytexas.gov](http://www.harriscountytexas.gov)

Covid-19: <https://publichealth.harriscountytexas.gov/Resources/2019-Novel-Coronavirus>

Twitter: @ReadyHarris

## Normal Weekly Virtual Schedule

Westside HS		Student Virtual Daily Schedule				
		MONDAY	TUESDAY	WEDNESDAY	THURSDAY	FRIDAY
		Periods 1,3,5,7 ONLY		Periods 2,4,6 ONLY		Periods 1-7
		Periods 1,3,5,7 academic work due on <b>Thursdays</b>		Periods 2,4,6 academic work due on <b>Mondays</b>		Student Interventions Differentiated Support
		Teacher-Directed Instruction <i>Intro to Learning Objective Instructional Process Teacher-Student Engagement (Live or Pre-recorded Lessons)</i>	Supplemental Teacher Directed Instruction <i>Independent Student Practice Performance Task Completion Progress Monitoring</i>	Teacher-Directed Instruction <i>Intro to Learning Objective Instructional Process Teacher-Student Engagement (Live or Pre-recorded Lessons)</i>	Supplemental Teacher Directed Instruction <i>Independent Student Practice Performance Task Completion Progress Monitoring</i>	Student Supports
9:30-12:00	<u>Per 1- 9:30-10:30</u>	<u>Per 1- 9:30-10:30</u>	<u>Per 2- 9:30 - 10:30</u>	<u>Per 2- 9:30 - 10:30</u>	Special Populations: Co-Teach Support and Collaboration	
	<u>Per 3- 11:00-12:00</u>	<u>Per 3- 11:00-12:00</u>	<u>Per 4- 11:00-12:00</u>	<u>Per 4- 11:00-12:00</u>		Social Emotional Referral/Support
	Lessons recorded & saved for student viewing- anytime.	More student-teacher interaction on this day	Lessons recorded & saved for student viewing- anytime.	More student-teacher interaction on this day	Teacher Supports PD/Training Peer Support Network; Grading Practices	
12:00-1:00	LUNCH	LUNCH	LUNCH	LUNCH	LUNCH	
1:00-3:00	<u>Per 5- 1:00- 2:00</u>	<u>Per 5- 1:00- 2:00</u>	<u>Per 6- 1:00 - 2:00</u>	<u>Per 6- 1:00 - 2:00</u>	TEACHER MEETING	
	<u>Per 7- 2:00- 3:00</u>	<u>Per 7- 2:00- 3:00</u>				
3:00-3:30	Troubleshooting/ Parent-Student Contact/Dean Referral	Troubleshooting/ Parent-Student Contact/Dean Referral	2:00 PM on WED & THURS TEACHER MEETINGS/ TECH TRAINING AND/OR SUPPORT UPON REQUEST		Teacher Lesson Plans posted for following week.	

## HISD Launches Home-Based Education



The Houston Independent School District is launching HISD @ H.O.M.E. (Home-based Online Mobile Education), a distance learning plan to ensure students' academic and non-academic needs are met as the district remains closed due to COVID-19 precautions. For additional general information, please go to: [HoustonISD.org/HOME](https://HoustonISD.org/HOME)

### Getting Started Survey

As HISD begins the remote learning program, we want to connect with all our families and be sure you have the tools needed for remote learning. The purpose of this survey is to collect information that will make families remote learning experience optimal. It is available in multiple languages at the same link.

Please take this HISD Survey

<https://www.surveymonkey.com/r/9VPFZ5Q>



## STAAR Testing Cancelled

Due to the impact of Covid-19, STAAR testing is cancelled for the remainder of the school year. This includes all STAAR Assessments and EOC (End of Course) Assessments. Click [here](#) for the announcement released by the Texas Education Agency (TEA).

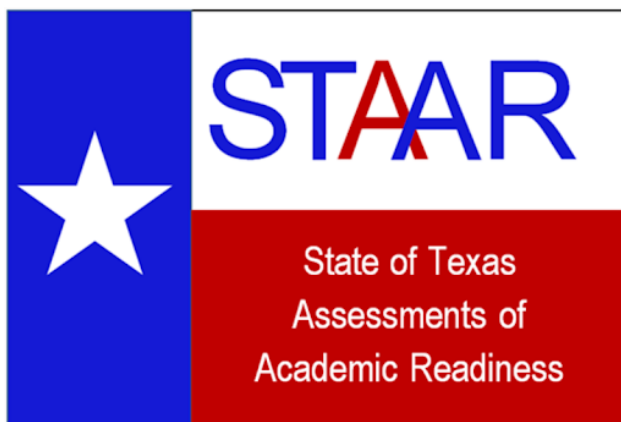

## Attention Juniors! School Day SAT Postponed

HISD has announced that the administration of the SAT School Day test planned for April 28, 2020 is rescheduled for October 14, 2020. Our class of current juniors will sit for the test in October when they are seniors.

It is important to note, juniors are advised to sign up for the June or August 2020 SAT if they wish to meet early action/early decision college application deadlines for Fall of 2021 admissions.

## National Testing Updates ACT, AP, and SAT

The ACT logo features the letters 'ACT' in a bold, black, serif font. A red swoosh underline is positioned beneath the 'A'.

**COVID-19**

**TEST UPDATES &  
STUDENT RESOURCES**

Click here:

<http://www.act.org/>



**COVID-19**

**INFO &  
RESOURCES**

Click Here:

<https://apcentral.collegeboard.org/about-ap/news-changes/coronavirus-update>



**CollegeBoard SAT**  
connect to college success™

**COVID-19**

**SAT UPDATES**

Click Here:

<https://pages.collegeboard.org/natural-disasters>

## The NEW Westside Way

*Wolves Helping Wolves*

SOME OF OUR FAMILIES  
ARE IN NEED

Make a donation toward  
GROCERY GIFT CARDS



Scan or Click [HERE](#)

*Westside PTO*

**Cycle 5**

Is

**EXTENDED**

To

**April 9**



**WELCOME  
WOLVES!**

To Our New  
Virtual  
Class Meetings  
on  
Microsoft  
**TEAMS**

## Resources You May Need

Need to talk?

Do you want emotional support?



EMAIL YOUR  
NAME AND  
ID NUMBER  
**ONLY**

One of us (Ms. McIntosh or Ms. Lumpkin) will create an appointment with you. Check your notification via **school** email within 24 hours.

Email:

[ciera.mcintosh@houstonisd.org](mailto:ciera.mcintosh@houstonisd.org)

Email:

[ebony.lumpkin@houstonisd.org](mailto:ebony.lumpkin@houstonisd.org)



**WESTSIDE**  
Student Support Center



**Here to assist our Wolves!**

Attendance Appeal  
Absences  
Emotional Support

**Monday-Friday 9-12 & 1-3:15**

[cbyrd@houstonisd.org](mailto:cbyrd@houstonisd.org)

[aaren.scott@houstonisd.org](mailto:aaren.scott@houstonisd.org)

TAKE CARE OF YOURSELVES,  
♥ WOLVES!



**COACH  
THOMAS**

WELCOME TO

*Physical  
Education*

Anytime. Anyplace!



At  
ONLINE  
your  
pace

**3/31-  
4/3  
WEEK  
OF**

**YOGA SERIES**

Learn beginners yoga.  
Invite people within your homes to  
join. Remember SOCIAL DISTANCING!



CHECK THE HUB FOR LINKS AND ASSIGNMENTS

## Resources You May Need

### Joining Microsoft Teams Meeting as a Student/Parent

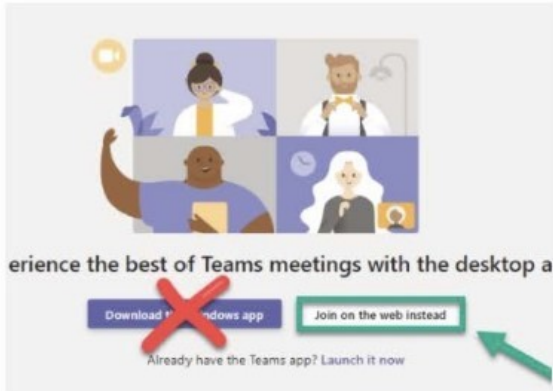

- 1 Click on the Invite link. In your browser window click on "Join on the web instead". NOTE: For the best experience use Google Chrome

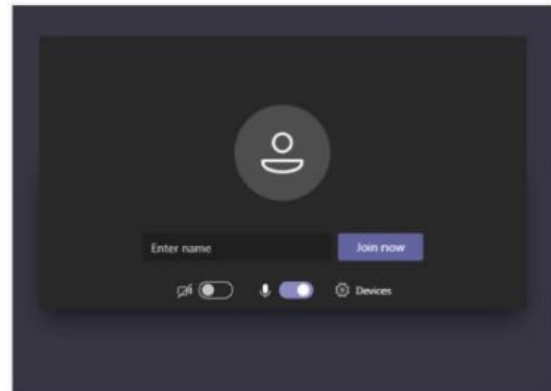

- 2 Enter your name. Turn on your camera and mic if necessary. Note: Your browser may ask permission to use your mic and camera.

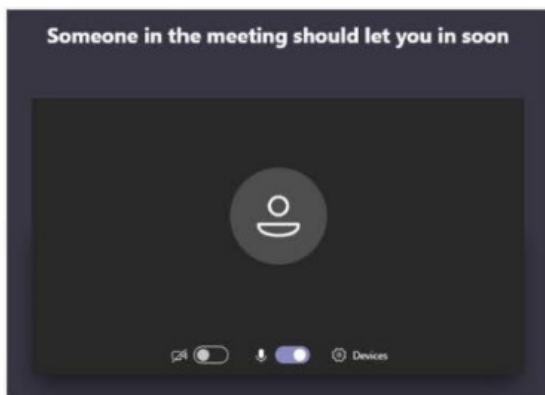

- 3 Wait to be let in to the meeting

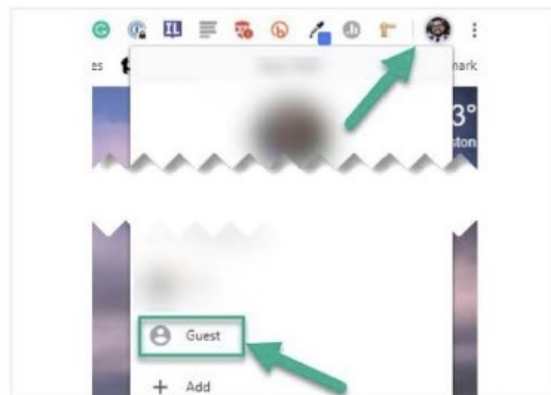

- 4 NOTE: If you receive an error try opening Chrome as a guest. Then copy and paste the link from your invite into the browser URL



## School News

### Amazonia!

By Ms. Willett

Computer Programming Pathway senior, Maggie Wong, was awarded a \$40,000 Amazon Scholarship. Amazon is a premier Westside partner in our Computer Programming and Computer Science Pathways. In addition to being the recipient of the \$40,000 scholarship, Maggie will be a summer intern with Amazon throughout her college years. Congratulations to Maggie!



### JV Girls Soccer Wins District

Before UIL activities came to an abrupt halt, JV Girls Soccer clinched their last game to become Back-to-Back District 18-6A JV Champions! They

rocked an undefeated pre- and conference-season with an official record of 16W-1T-0L. [#WorkWins](#) Congratulations to our Lady Wolves!





## The New Way We Do School



Students!  
Check your HISD Student Email Regularly

## Announcements



Sophomores & Juniors!

### **NHS Application Deadline EXTENDED to April 3**

Were you expecting an invitation to join  
NHS and did not receive it?

Email your Dean ASAP

Questions: [jschroe1@houstonisd.org](mailto:jschroe1@houstonisd.org)

The Westside Wolves logo is located in the top left corner of the poster. It features a stylized black and white wolf head facing right, with the word "WESTSIDE" in a bold, italicized font above it and "WOLVES" in a similar font below it.

**CLASS  
OF 2020**

*We know you have  
questions & concerns!*

**SEND YOUR QUESTIONS TO  
THE SENIOR CLASS REMIND**

**TO JOIN:**

**TEXT @2020WOLF1 TO 81010**

**NO PARENTS PLEASE...SAFE SPACE FOR STUDENTS**

Westside High School

A silhouette of a wolf is shown howling at a large, bright full moon. The wolf is standing on a rocky outcrop, and some dark foliage is visible in the foreground. The background is a deep blue with some light clouds.

**Home  
Of the  
Wolves**



## Announcements



Comcast Announces  
Comprehensive  
COVID-19 Response  
to  
Help Keep Americans  
Connected to the Internet

Free Wifi from Comcast:  
<https://corporate.comcast.com/covid-19>

From Our  
Westside Counselor:

Social Emotional Guide  
for  
Parents and Teachers

Resources for Parents, Educators  
& School Communities  
Related to COVID-19

<https://insidesel.com/2020/03/12/covid-19/>



THE 20TH  
EDITION  
OF THE  
WESTSIDE  
CANIDAE

YEAR  
BOOK

[www.balfour.com](http://www.balfour.com)

&

Yes, we will have a  
YEARBOOK!

**\$85**

Questions?

[srobert2@houstonisd.org](mailto:srobert2@houstonisd.org)





**Celebrating  
20 Years  
Of  
Excellence  
Est. 2000**

## Quick Links

Submit stories and photos for eNews:

[barbara.nassab@houstonisd.org](mailto:barbara.nassab@houstonisd.org)

Register for Parent Student Connect/  
GradeSpeed:

<https://www.houstonisd.org/Page/42143>

Subscribe to receive eNews by email:

[https://mailman.listserve.com/listmanager/  
listinfo/whscommunity](https://mailman.listserve.com/listmanager/listinfo/whscommunity)

School Pay:

<https://www.schoolpay.com/>

School Web Address:

<https://www.houstonisd.org/westsidehs>

HISD Web Address:

<https://www.houstonisd.org>